

Notes:

o/ drawn using 18mm material

1/ triangle at back of CC is of undetermined dimension -- its purpose is to combat port-to-port interference

3/ the mouth deflectors can be built using the stepped strips or replaced with a single piece deflector (outside edge depicted in red). The stepped version starts with the longest piece half the material thickness back from the (nominal) front and then each subsequent piece is thickness of the material shorter.

4/ Can be used with FE206e with the addition of series resistance (4 ohms suggested)

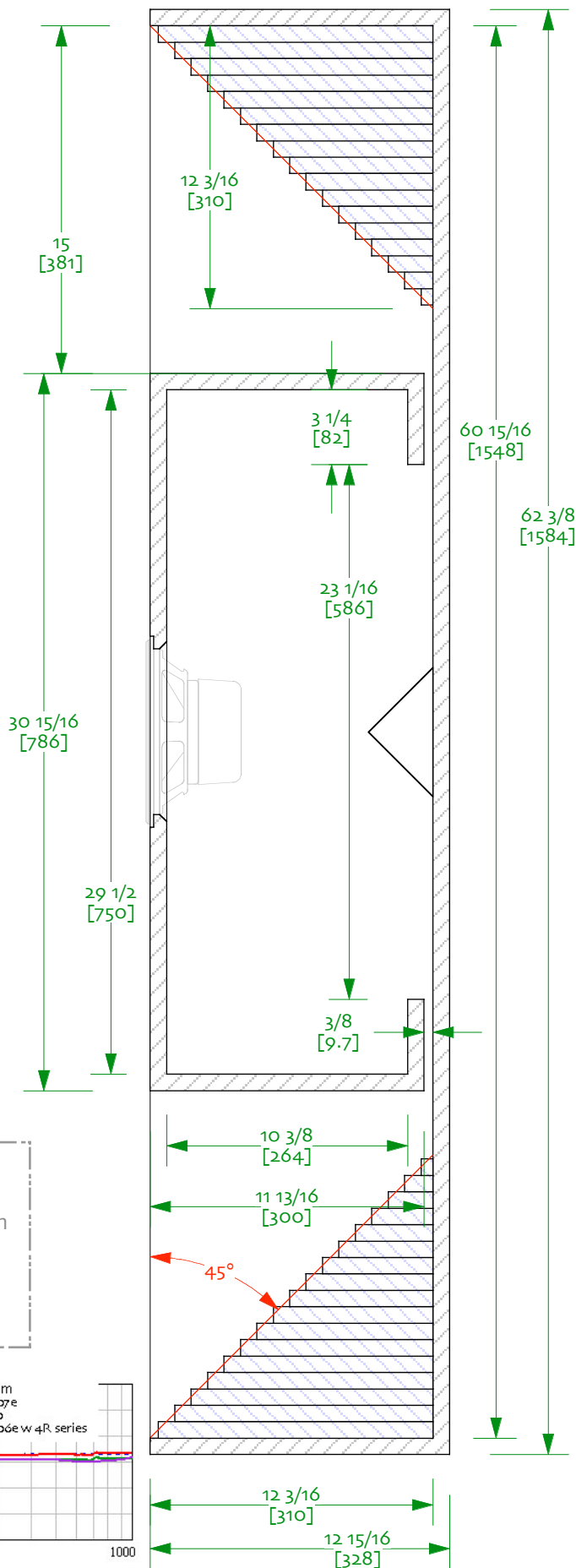
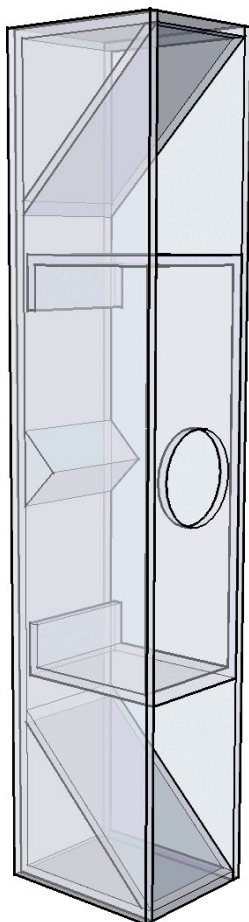

VIKING

Chang – Descendant of Calhoun –
Fostex FE207e / Pioneer B20
Nagaoko-style/Double Mouth BVR Horn

1VO1
Sheet 0 -- panel placement
designed by Scott Lindgren
drawn by dld

17-july-2007 / updated 13-aug-2007

